



FOUR SEASONS RESORT
Hualalalai at Historic Ka'upulehu

Venues

Reward your event attendees with an island paradise that captures the essence of Hawai'i's golden age. Set on the exclusive Kona-Kohala Coast, Four Seasons Resort Hualalalai at Historic Ka'upulehu offers you the unrivalled experience of the only AAA Five Diamond and Forbes Five Star Resort on Hawai'i, the Big Island.

Adaptable venues under Hawai'i Island skies—from beachside to the open-air, lava-rock Hoku Amphitheatre—are immersed in the landscape's raw beauty. Imaginative menus use local ingredients, showcasing true farm-to-table island dining. Our chefs create menus that change to reflect the seasons and offer tempting variety: the bounty of Hawaii's land and oceans, Tuscan cucina rustica, beachfront barbecues, Asian-Pacific cuisine, Polynesian pupus (appetisers). Four Seasons expertise ensures your event will have the aloha spirit that is unmistakably Hualalalai.

Venues

Resort Map

Hualalai Ballroom

Meeting Rooms

Hoku Amphitheatre

Beach Tree Lawn

Garden Lawn

Kumukea Beach

Sea Shell Pool

Ronnie's Garden

Palm Grove Lawn

Beach Tree Restaurant

Moana Terrace

'ULU Ocean Grill

Driving Range

After Hours

Contact Us



Venues

Hualalai Ballroom

Neutral earth tones and rich, dark woods provide a perfect canvas to feature your event and complement a variety of decor and linen options. The Hualalai Ballroom opens to a spacious indoor foyer with full-length sliding glass doors. Using half of the ballroom, you can extend the celebration with late-night dancing after dining under the stars at the Garden Lawn.

Dimension

65 x 95 feet

Size: 6,175 square feet

Events

Breakfast

Brunch

Meetings

Coffee Break

Lunch

Reception

Dinner

After Hours

Compatible Color Schemes

Royal Blue

Turquoise

Gold

Chocolate Brown



Resort Map

Hualalai Ballroom

Meeting Rooms

Hoku Amphitheatre

Beach Tree Lawn

Garden Lawn

Kumukea Beach

Sea Shell Pool

Ronnie's Garden

Palm Grove Lawn

Beach Tree Restaurant

Moana Terrace

'ULU Ocean Grill

Driving Range

After Hours

Contact Us

Venues

Meeting Rooms

Four, ground level, air-conditioned meeting rooms sit adjacent to Hualalai Ballroom. Each meeting room opens to a small lanai area and displays the same neutral earth tones and rich, dark wood décor found in the Ballroom.

Mauna Kea Dimension

20 x 39 feet

Size: 780 square feet (divisible by 2)

Lo'ihl Dimension

20 x 24 feet

Size: 480 square feet

Kilauea Dimension

20 x 24 feet

Size: 480 square feet

Mauna Loa Dimension

19 x 25 feet

Size: 475 square feet

Events

Breakfast
Meetings
Hospitality
Coffee Break
Lunch
After Hours

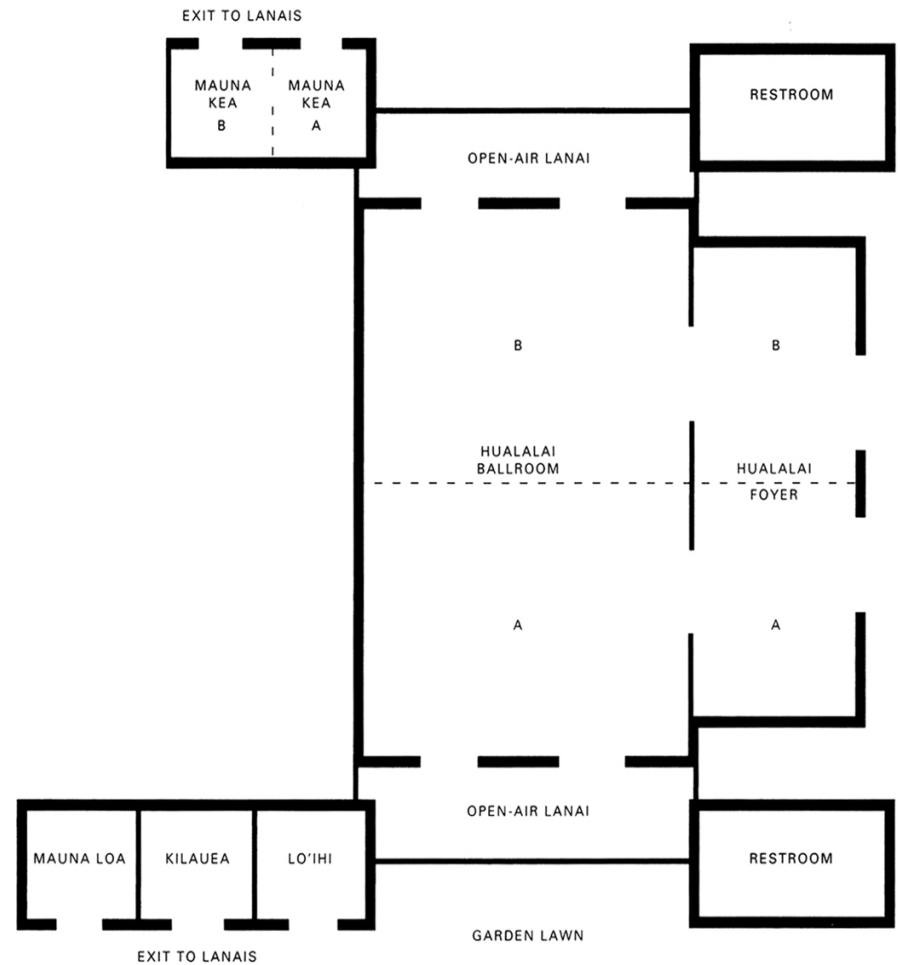

ALL MEETING ROOMS HAVE AN OUTDOOR ORIENTATION



Resort Map

Hualalai Ballroom

Meeting Rooms

Hoku Amphitheatre

Beach Tree Lawn

Garden Lawn

Kumukea Beach

Sea Shell Pool

Ronnie's Garden

Palm Grove Lawn

Beach Tree Restaurant

Moana Terrace

'ULU Ocean Grill

Driving Range

After Hours

Contact Us

Venues

Hoku Amphitheatre

A truly unique terraced amphitheatre, *Hoku Amphitheatre* is carved from the historic Ka'upulehu lava flow. A dramatic lava rock wall is the backdrop to your entertainment and dancing while your guests dine underneath tropical skies. Illuminated by the evening stars (*hoku* is Hawaiian for star) this versatile venue can host events ranging from black-tie affairs to casual Hawaiian luaus.

Dimension

90 x 90 feet

Size: 8,100 square feet

Events

Breakfast

Brunch

Lunch

Reception

Dinner



[Resort Map](#)

[Hualalai Ballroom](#)

[Meeting Rooms](#)

[Hoku Amphitheatre](#)

[Beach Tree Lawn](#)

[Garden Lawn](#)

[Kumukea Beach](#)

[Sea Shell Pool](#)

[Ronnie's Garden](#)

[Palm Grove Lawn](#)

[Beach Tree Restaurant](#)

[Moana Terrace](#)

['ULU Ocean Grill](#)

[Driving Range](#)

[After Hours](#)

[Contact Us](#)

Venues

[Resort Map](#)

[Hualalai Ballroom](#)

[Meeting Rooms](#)

[Hoku Amphitheatre](#)

[Beach Tree Lawn](#)

[Garden Lawn](#)

[Kumukea Beach](#)

[Sea Shell Pool](#)

[Ronnie's Garden](#)

[Palm Grove Lawn](#)

[Beach Tree Restaurant](#)

[Moana Terrace](#)

['ULU Ocean Grill](#)

[Driving Range](#)

[After Hours](#)

[Contact Us](#)



Venues

Resort Map

Hualalai Ballroom

Meeting Rooms

Hoku Amphitheatre

Beach Tree Lawn

Garden Lawn

Kumukea Beach

Sea Shell Pool

Ronnie's Garden

Palm Grove Lawn

Beach Tree Restaurant

Moana Terrace

`ULU Ocean Grill

Driving Range

After Hours

Contact Us

Beach Tree Lawn

On the emerald grass of *Beach Tree Lawn*, overlooking the Beach Tree Pool, your guests will delight in spectacular views of the blue Pacific Ocean. The warm ocean breezes and clear tropical skies help create an unforgettable event.

Dimension

47 x 47 feet

Size: 2,200 square feet

Events

Breakfast

Brunch

Lunch

Reception

Dinner

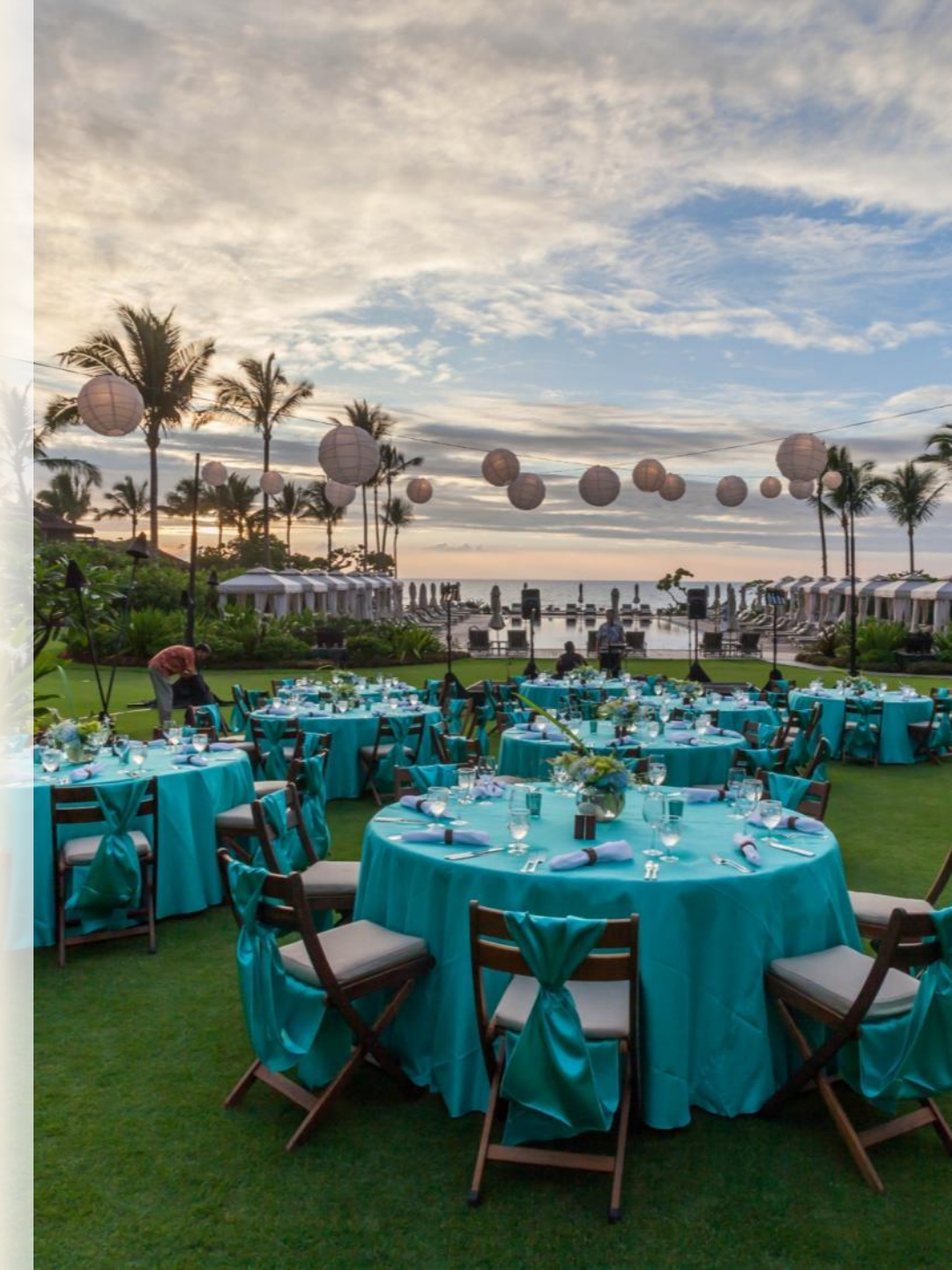

Venues

[Resort Map](#)

[Hualalai Ballroom](#)

[Meeting Rooms](#)

[Hoku Amphitheatre](#)

[Beach Tree Lawn](#)

[Garden Lawn](#)

[Kumukea Beach](#)

[Sea Shell Pool](#)

[Ronnie's Garden](#)

[Palm Grove Lawn](#)

[Beach Tree Restaurant](#)

[Moana Terrace](#)

['ULU Ocean Grill](#)

[Driving Range](#)

[After Hours](#)

[Contact Us](#)



Venues

Resort Map

Hualalai Ballroom

Meeting Rooms

Hoku Amphitheatre

Beach Tree Lawn

Garden Lawn

Kumukea Beach

Sea Shell Pool

Ronnie's Garden

Palm Grove Lawn

Beach Tree Restaurant

Moana Terrace

`ULU Ocean Grill

Driving Range

After Hours

Contact Us

Garden Lawn

Surrounded by royal poinciana trees, plumeria and red hibiscus, *Garden Lawn* is our outdoor living room. This versatile venue, adjacent to the Hualalai Ballroom, is perfect for small gatherings or exclusive dining occasions. Evening events are accentuated by the glow of tiki torches or lanterns. Guests looking to continue festivities into the night can transition inside to enjoy a creative dessert buffet with nightcaps.

Dimension

50 x 70 feet

Size: 3,500 square feet

Events

Breakfast

Brunch

Lunch

Reception

Dinner



Venues

[Resort Map](#)

[Hualalai Ballroom](#)

[Meeting Rooms](#)

[Hoku Amphitheatre](#)

[Beach Tree Lawn](#)

[Garden Lawn](#)

[Kumukea Beach](#)

[Sea Shell Pool](#)

[Ronnie's Garden](#)

[Palm Grove Lawn](#)

[Beach Tree Restaurant](#)

[Moana Terrace](#)

['ULU Ocean Grill](#)

[Driving Range](#)

[After Hours](#)

[Contact Us](#)



Venues

[Resort Map](#)

[Hualalai Ballroom](#)

[Meeting Rooms](#)

[Hoku Amphitheatre](#)

[Beach Tree Lawn](#)

[Garden Lawn](#)

[Kumukea Beach](#)

[Sea Shell Pool](#)

[Ronnie's Garden](#)

[Palm Grove Lawn](#)

[Beach Tree Restaurant](#)

[Moana Terrace](#)

['ULU Ocean Grill](#)

[Driving Range](#)

[After Hours](#)

[Contact Us](#)

Kumukea Beach

A delicate white-sand beach on the northern end of the King's Pond crescent, this secluded location is a favorite stop for sea turtles. *Kumukea Beach* is ideal for special ceremonies, dinners, welcome receptions and family-style meals.

Dimension

40 x 25 feet

Size: 1,000 square feet

Events

Breakfast

Lunch

Reception

Dinner



Venues

[Resort Map](#)

[Hualalai Ballroom](#)

[Meeting Rooms](#)

[Hoku Amphitheatre](#)

[Beach Tree Lawn](#)

[Garden Lawn](#)

[Kumukea Beach](#)

[Sea Shell Pool](#)

[Ronnie's Garden](#)

[Palm Grove Lawn](#)

[Beach Tree Restaurant](#)

[Moana Terrace](#)

['ULU Ocean Grill](#)

[Driving Range](#)

[After Hours](#)

[Contact Us](#)



Venues

Resort Map

Hualalai Ballroom

Meeting Rooms

Hoku Amphitheatre

Beach Tree Lawn

Garden Lawn

Kumukea Beach

Sea Shell Pool

Ronnie's Garden

Palm Grove Lawn

Beach Tree Restaurant

Moana Terrace

'ULU Ocean Grill

Driving Range

After Hours

Contact Us

Seashell Pool

With its infinity edge, the lagoon-shaped *Seashell Pool* gives the illusion of blending with the ocean. The pool enclosure is the perfect location to enjoy spectacular ocean sunsets during an evening cocktail reception.

Dimension:

210 x 25 feet

Size: 5,250 square feet

Events

Reception

Dinner



Venues

Resort Map

Hualalai Ballroom

Meeting Rooms

Hoku Amphitheatre

Beach Tree Lawn

Garden Lawn

Kumukea Beach

Sea Shell Pool

Ronnie's Garden

Palm Grove Lawn

Beach Tree Restaurant

Moana Terrace

'ULU Ocean Grill

Driving Range

After Hours

Contact Us

Ronnie's Garden

Adjacent to the 18th green, *Ronnie's Garden* is a great location for an après golf luncheon, a culturally inspired evening reception.

Dimension:

65x 60 feet

Size: 3,900 square feet

Events

Breakfast

Lunch

Reception

Dinner



Venues

[Resort Map](#)

[Hualalai Ballroom](#)

[Meeting Rooms](#)

[Hoku Amphitheatre](#)

[Beach Tree Lawn](#)

[Garden Lawn](#)

[Kumukea Beach](#)

[Sea Shell Pool](#)

[Ronnie's Garden](#)

[Palm Grove Lawn](#)

[Beach Tree Restaurant](#)

[Moana Terrace](#)

[`ULU Ocean Grill](#)

[Driving Range](#)

[After Hours](#)

[Contact Us](#)

Palm Grove Lawn

Situated beneath towering palm trees your event will have the Pacific Ocean as its backdrop. *Palm Grove Lawn* is a spectacular oceanfront location for a light reception while the sun sinks into the ocean.

Dimension

80 x 60 feet

Size: 4,800 square feet

Events

Small Reception



Venues

[Resort Map](#)

[Hualalai Ballroom](#)

[Meeting Rooms](#)

[Hoku Amphitheatre](#)

[Beach Tree Lawn](#)

[Garden Lawn](#)

[Kumukea Beach](#)

[Sea Shell Pool](#)

[Ronnie's Garden](#)

[Palm Grove Lawn](#)

[***Beach Tree Restaurant***](#)

[Moana Terrace](#)

[`ULU Ocean Grill](#)

[Driving Range](#)

[After Hours](#)

[Contact Us](#)

Beach Tree

Nestled ocean-front is the delightful alfresco dining of *Beach Tree*. The outdoor and trellised seating of the restaurant allow for private group breakfasts with dazzling ocean views.

Dimension:

53 x 49 feet

Size: 2,597 square feet

Events

Breakfast Only



Venues

[Resort Map](#)

[Hualalai Ballroom](#)

[Meeting Rooms](#)

[Hoku Amphitheatre](#)

[Beach Tree Lawn](#)

[Garden Lawn](#)

[Kumukea Beach](#)

[Sea Shell Pool](#)

[Ronnie's Garden](#)

[Palm Grove Lawn](#)

[Beach Tree Restaurant](#)

[Moana Terrace](#)

['ULU Ocean Grill](#)

[Driving Range](#)

[After Hours](#)

[Contact Us](#)

Moana Terrace

Located on the upper level of 'ULU Ocean Grill + Sushi Lounge, *Moana Terrace* offers panoramic views of the ocean in an intimate setting that is ideal for private dining events for up to 40 people or an ocean-side hospitality suite.

Maximum capacity:

40 guests

Events

Hospitality

Reception

Dinner



Venues

[Resort Map](#)

[Hualalai Ballroom](#)

[Meeting Rooms](#)

[Hoku Amphitheatre](#)

[Beach Tree Lawn](#)

[Garden Lawn](#)

[Kumukea Beach](#)

[Sea Shell Pool](#)

[Ronnie's Garden](#)

[Palm Grove Lawn](#)

[Beach Tree Restaurant](#)

[Moana Terrace](#)

['ULU Ocean Grill](#)

[Driving Range](#)

[After Hours](#)

[Contact Us](#)

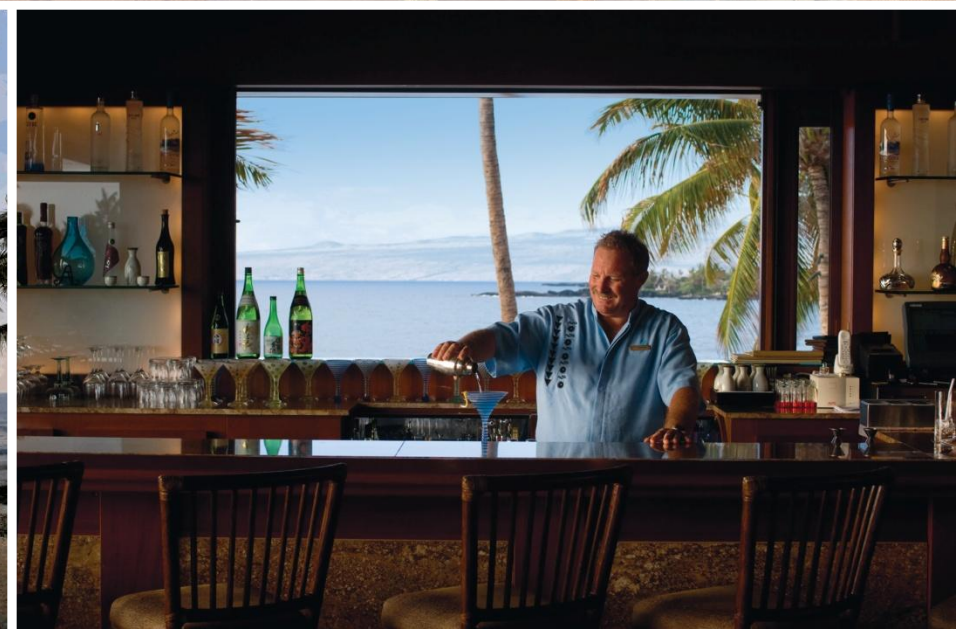

Venues

Resort Map

Hualalai Ballroom

Meeting Rooms

Hoku Amphitheatre

Beach Tree Lawn

Garden Lawn

Kumukea Beach

Sea Shell Pool

Ronnie's Garden

Palm Grove Lawn

Beach Tree Restaurant

Moana Terrace

'ULU Ocean Grill

Driving Range

After Hours

Contact Us

'ULU Ocean Grill and Sushi Lounge

This stunning ocean front restaurant offers two semi-private dining spaces, each just steps away from the vast cobalt-blue ocean and rolling waves. The *Kohala Room* located at the north end of the restaurant can seat up to 30 guests and offers an adjacent buffet area. While *Makai Lanai* is the optimal spot for table side cooking and beachside receptions. As these rooms are part of our restaurant, we are unable to accommodate entertainment or dancing in this space.

Kohala Room Maximum Capacity:
30 guests

Makai Lanai Maximum Capacity:
42 guests

Events

Lunch
Reception
Dinner



Venues

[Resort Map](#)

[Hualalai Ballroom](#)

[Meeting Rooms](#)

[Hoku Amphitheatre](#)

[Beach Tree Lawn](#)

[Garden Lawn](#)

[Kumukea Beach](#)

[Sea Shell Pool](#)

[Ronnie's Garden](#)

[Palm Grove Lawn](#)

[Beach Tree Restaurant](#)

[Moana Terrace](#)

['ULU Ocean Grill](#)

[Driving Range](#)

[After Hours](#)

[Contact Us](#)



Venues

Hualalai Golf Course

Driving Range

The nine acre driving range, on the Hualalai Golf Course, is an ideal spot for large functions

Dimension:

200 x 55 feet

Size: 11,000 square feet

Events

Reception

Dinner

*Rental Fee Applies

Resort Map

Hualalai Ballroom

Meeting Rooms

Hoku Amphitheatre

Beach Tree Lawn

Garden Lawn

Kumukea Beach

Sea Shell Pool

Ronnie's Garden

Palm Grove Lawn

Beach Tree Restaurant

Moana Terrace

`ULU Ocean Grill

Driving Range

After Hours

Contact Us



Venues

[Resort Map](#)

[Hualalai Ballroom](#)

[Meeting Rooms](#)

[Hoku Amphitheatre](#)

[Beach Tree Lawn](#)

[Garden Lawn](#)

[Kumukea Beach](#)

[Sea Shell Pool](#)

[Ronnie's Garden](#)

[Palm Grove Lawn](#)

[Beach Tree Restaurant](#)

[Moana Terrace](#)

['ULU Ocean Grill](#)

[Driving Range](#)

[After Hours](#)

[Contact Us](#)

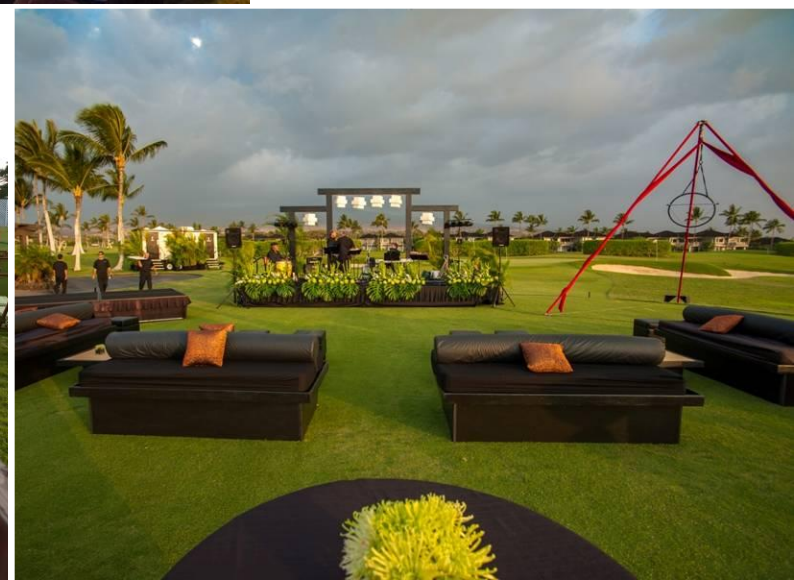

Venues

[Resort Map](#)

[Hualalai Ballroom](#)

[Meeting Rooms](#)

[Hoku Amphitheatre](#)

[Beach Tree Lawn](#)

[Garden Lawn](#)

[Kumukea Beach](#)

[Sea Shell Pool](#)

[Ronnie's Garden](#)

[Palm Grove Lawn](#)

[Beach Tree Restaurant](#)

[Moana Terrace](#)

['ULU Ocean Grill](#)

[Driving Range](#)

[After Hours](#)

[Contact Us](#)

After Hours Functions

Whether a dance party in the ballroom or a martini lounge at the spa, treat attendees to a unique *After Hours Event*.

After Hour Venue Options

Hualalai Ballroom
Mauna Kea Meeting Room
Moana Terrace
Hualalai Spa



Venues

[Resort Map](#)

[Hualalai Ballroom](#)

[Meeting Rooms](#)

[Hoku Amphitheatre](#)

[Beach Tree Lawn](#)

[Garden Lawn](#)

[Kumukea Beach](#)

[Sea Shell Pool](#)

[Ronnie's Garden](#)

[Palm Grove Lawn](#)

[Beach Tree Restaurant](#)

[Moana Terrace](#)

['ULU Ocean Grill](#)

[Driving Range](#)

[After Hours](#)

[Contact Us](#)



Mahalo

Contact Us

Four Seasons Resort Hualalai at Historic Ka'upulehu
72-100 Ka'upulehu Drive
Kailua-Kona, Hawaii 96740, U.S.A.
Tel. 1 (808) 325-8000 Fax. 1 (808) 325-8200

For more information on event space please click on the link below:

[Four Seasons Resort Hualalai Event Space](#)



FOUR SEASONS RESORT
Hualalāi at Historic Ka'ūpūlehu

